

# ST 200 DC

DC PUMPS

**EN.** High flow rate portable dispenser unit. ST 200 dispenses diesel fuel at a rate of up to 185 l/min and controls the flow with great precision (+/- 1%) thanks to the oval-gear flow meter (on request).

**ES.** Unidad móvil de trasiego para caudal elevado. ST 200 suministra gasoleo de hasta 185 l/min y controla el flujo con precisión (+/-1%) por medio del medidor mecánico con engranajes ovalados (a petición).

**RU.** Высокопроизводительный переносной узел подачи. ST 200 DC подает дизельное топливо со скоростью до 185 л/мин и контролирует поток с точностью (+/- 1%) благодаря счетчику литров с овальными шестернями (по заказу).

## PERFORMANCE

- Flow rate up to 185 l/min
- Duty cycle 20 min ON / 40 min OFF
- Power supply 24 V DC

- Caudal hasta 185 l/min
- Ciclo de funcionamiento 20 min ON / 40 min OFF
- Alimentación 24V CC

- Расход до 185 л/мин
- Рабочий цикл 20 мин ВКЛ / 40 мин ВЫКЛ
- Питание 24 В пост. тока

## DIMENSIONS

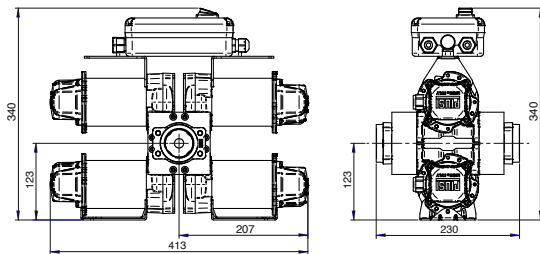

## PRODUCTS' RANGE WEIGHT AND PACKAGING

Code	Weight		Packaging		
	kg	lbs	mm	inch	pcs/box
F00318000	18	40	480x370x265	18,9x14,6x10,4	1



Flow-rate

up to  
**185** l/min  
(up to 48 gpm)



**PIUSI**<sup>®</sup>

DISPENSERS

PUMPS

METERS

NOZZLE  
METERS

NOZZLE

SPECIAL  
EQUIPMENTS

FLUID  
MONITORING

HOSE  
REEL

FILTERING

ACCESSORIES

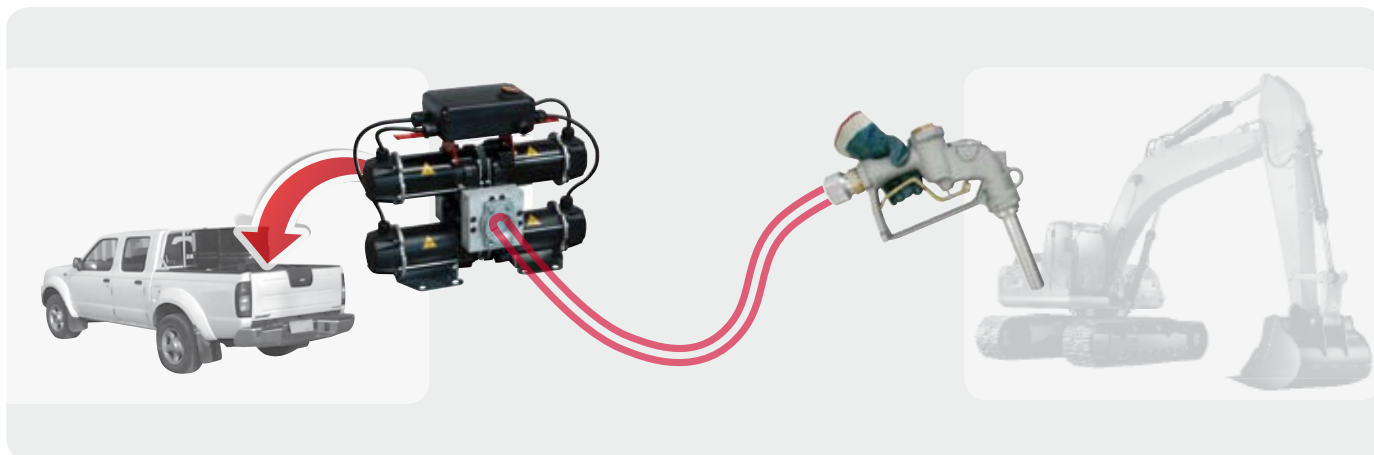
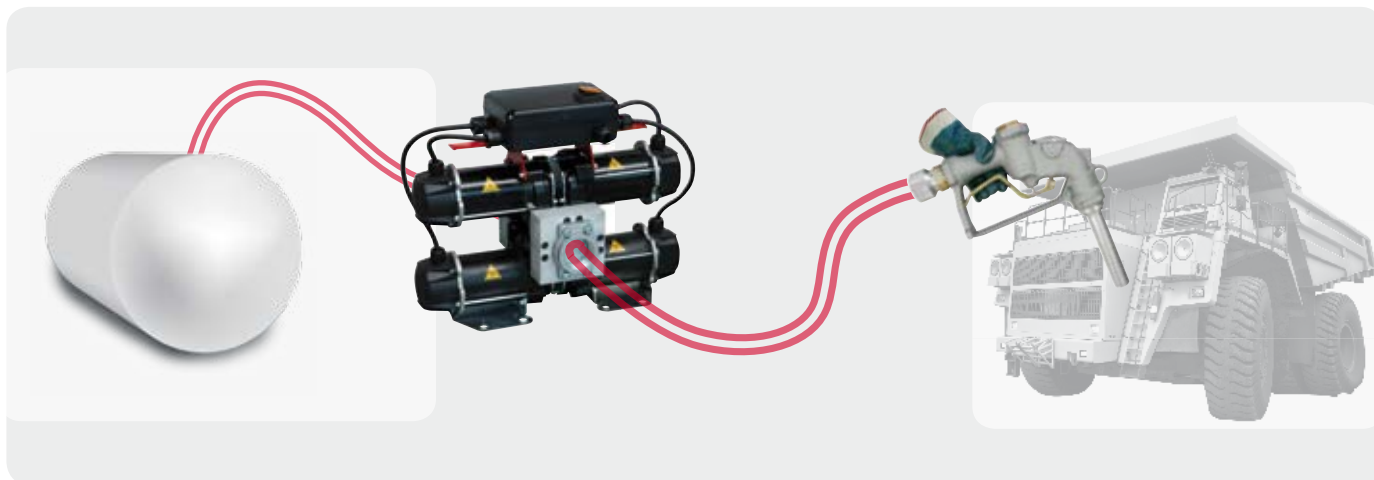

**FEATURES**

Electric cable



Electric cables with clamps (4 mt)

On/off switch



**ON REQUEST**

Meter K700 M



Flow rate:  
20 - 220 l/min  
Accuracy: +/- 1%  
Oval gear system  
Code: F00540000

Nozzle A280



Flow rate 280 l/min  
with swivel  
Code: F13249000

Hose Kit 1" 1/2

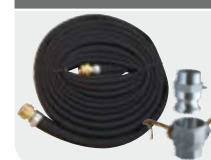

Code: F18798000  
(delivery hose 10 mt + Camlock)  
Code: F18799000  
(delivery hose 20 mt + Camlock)

**PRODUCTS' RANGE** TECHNICAL DATA

Code	Description	Fluids type	Flow-rate		Voltage			Duty cycle min.	Pump		Max pressure bar	Inlet BSP
			l/min	gpm	AC V./Hz DC Volt	Power Watt	Amp. max.		mod.	no.		
F00318000	ST 200 DC 24 V	D	155-185	42 - 48	24	1200	50	30	Bypass 3000	4	2	1" 1/2